

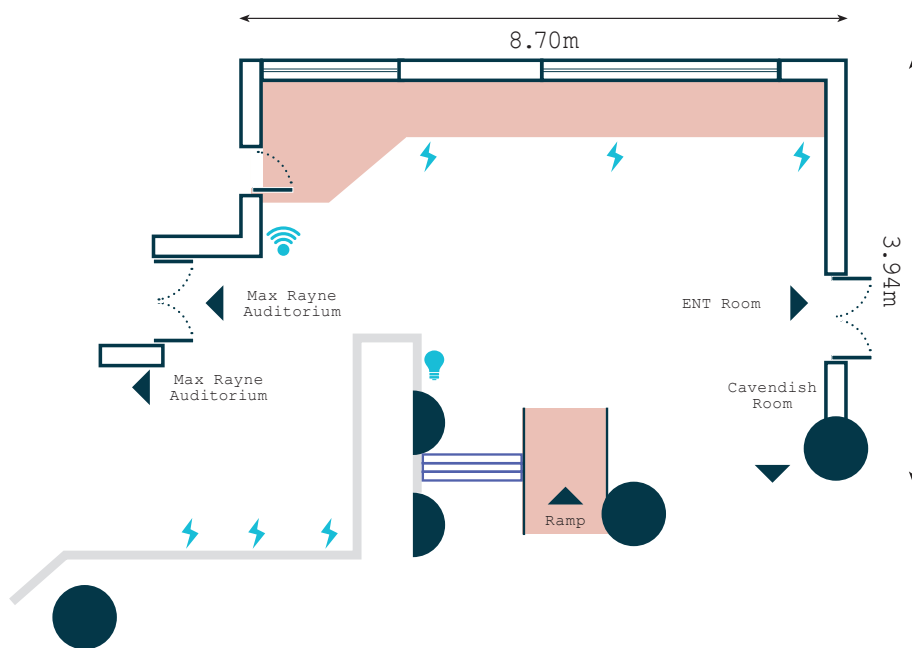

# Room Guide:

## Max Rayne Foyer

This flat floored room is conveniently located on the ground floor next to the Max Rayne Auditorium. It works well as a catering or exhibition area, located next to the ENT Room, offering a larger space when booked together.



### Dimensions







Length: 8.70m  
 Width: 3.94m  
 Height(highest point): 2.99m

### Capacities

Reception: 80  
 Standing Buffet: 60  
 Seated Buffet: 40

### Key Items Included In Room Hire

- Catering area
- Internet access with Wi-Fi

- |                                                                                                           |                                                                                                  |
|-----------------------------------------------------------------------------------------------------------|--------------------------------------------------------------------------------------------------|
|  Power Plug            |  Pillar       |
|  Wired Internet Access |  Glass Window |
|  Light Control         |  Step         |