

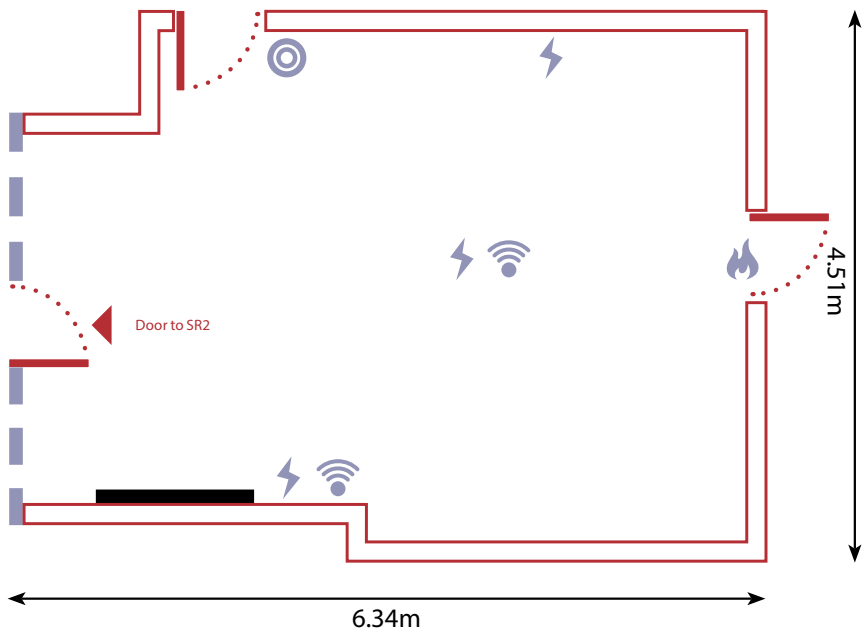

WIMPOLE_{St}

ROOM GUIDE: Seminar Room 1



CAPACITIES

- Theatre:** 15
- Boardroom:** 12
- Reception:** 20
- Standing Buffet:** 15

DIMENSIONS

- Length:** 6.34m
- Width:** 4.51m
- Height:** (highest point): 2.60m

KEY ITEMS INCLUDED IN ROOM HIRE

- 52" HD LCD monitor
- Internet access with Wi-Fi

-  Climate Control
-  Power Plug
-  Fire Exit
-  Wired Internet Access
-  LCD Screen
-  Moveable Wall



WIMPOLE_{St}

ROOM GUIDE: Seminar Room 2

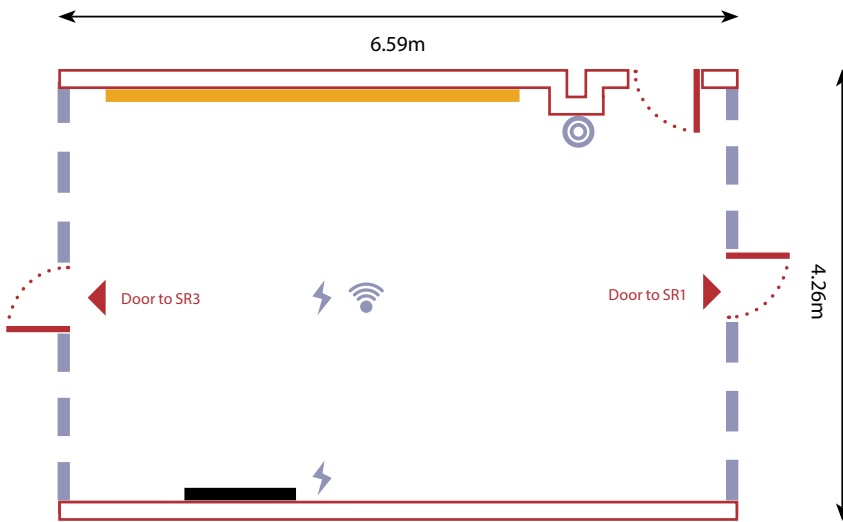

CAPACITIES

Theatre: 20
Boardroom: 14
Reception: 20
Standing Buffet: 15

DIMENSIONS

Length: 6.59m
Width: 4.26m
Height: (highest point): 2.60m

KEY ITEMS INCLUDED IN ROOM HIRE

- 52" HD LCD monitor
- Internet access with Wi-Fi

- ⊙ Climate Control
- ⚡ Power Plug
- 📶 Wired Internet Access

- LCD Screen
- Dry Wipe Board
- Moveable Wall



ROOM GUIDE: Seminar Room 3

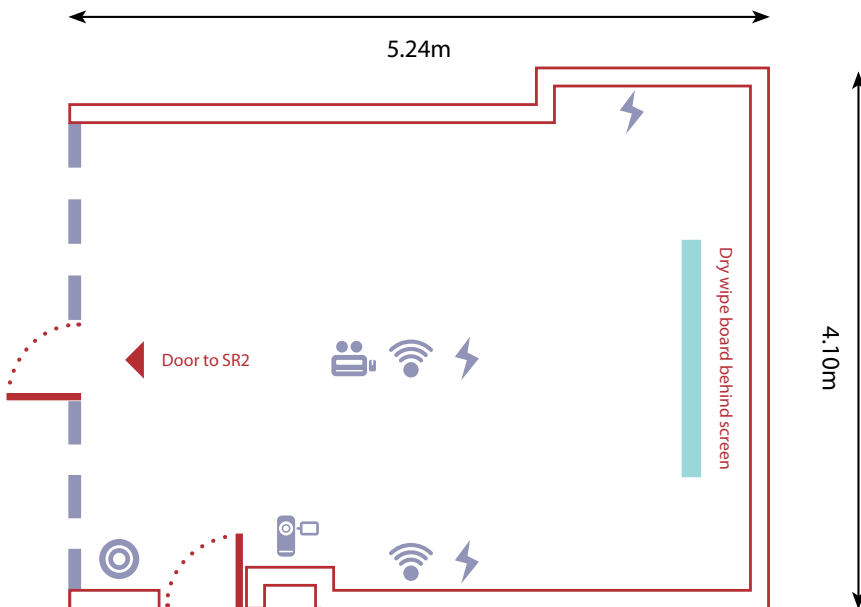

CAPACITIES

- Theatre:** 24
- Boardroom:** 16
- Reception:** 20
- Standing Buffet:** 15

DIMENSIONS

- Length:** 5.24m
- Width:** 4.10m
- Height:** (highest point): 2.60m

KEY ITEMS INCLUDED IN ROOM HIRE

- High definition, high brightness projector
- Internet access with Wi-Fi
- Induction loop for assistive listening

 Climate Control

 Projector

 Power Plug

 Projector Screen

 Wired Internet Access

 Moveable Wall

 Video Camera

FLOOR GUIDE

3rd FLOOR

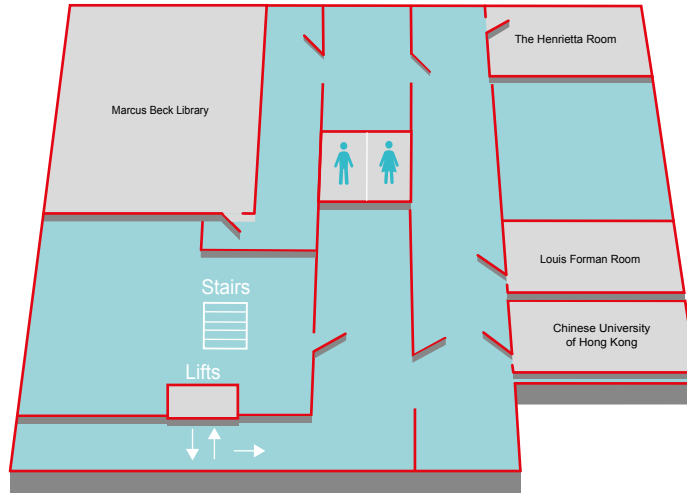

GROUND FLOOR



LOWER GROUND FLOOR

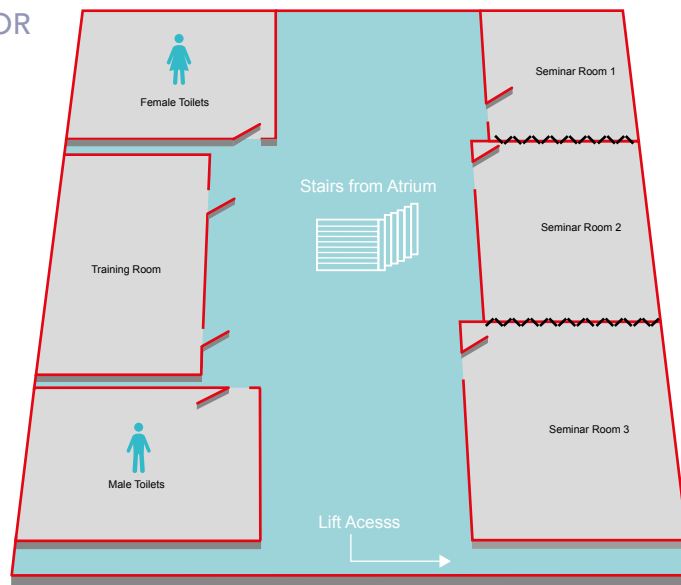

GROUND FLOOR

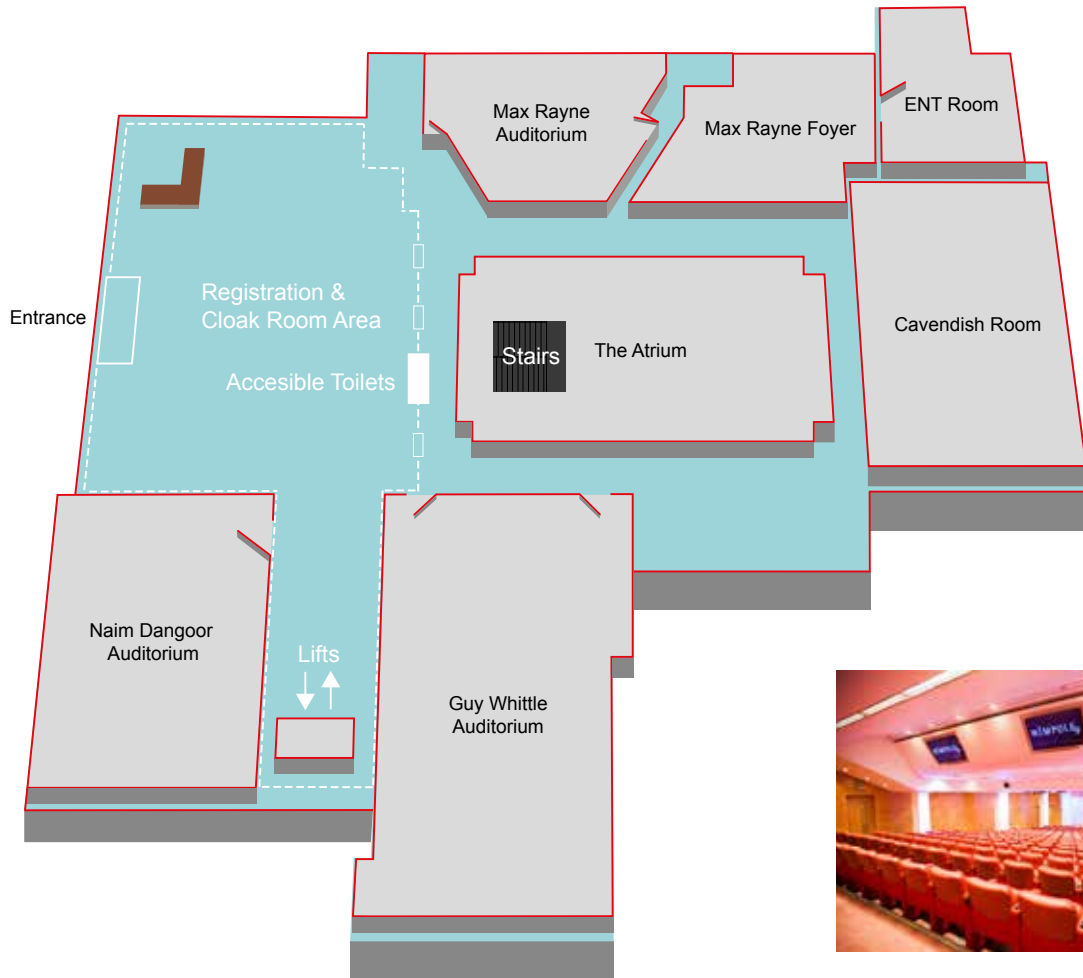

Guy Whittle Auditorium



Naim Dangoor Auditorium



ENT Room



The Atrium



Max Rayne Auditorium



Max Rayne Foyer



Cavendish Room

LOWER GROUND FLOOR

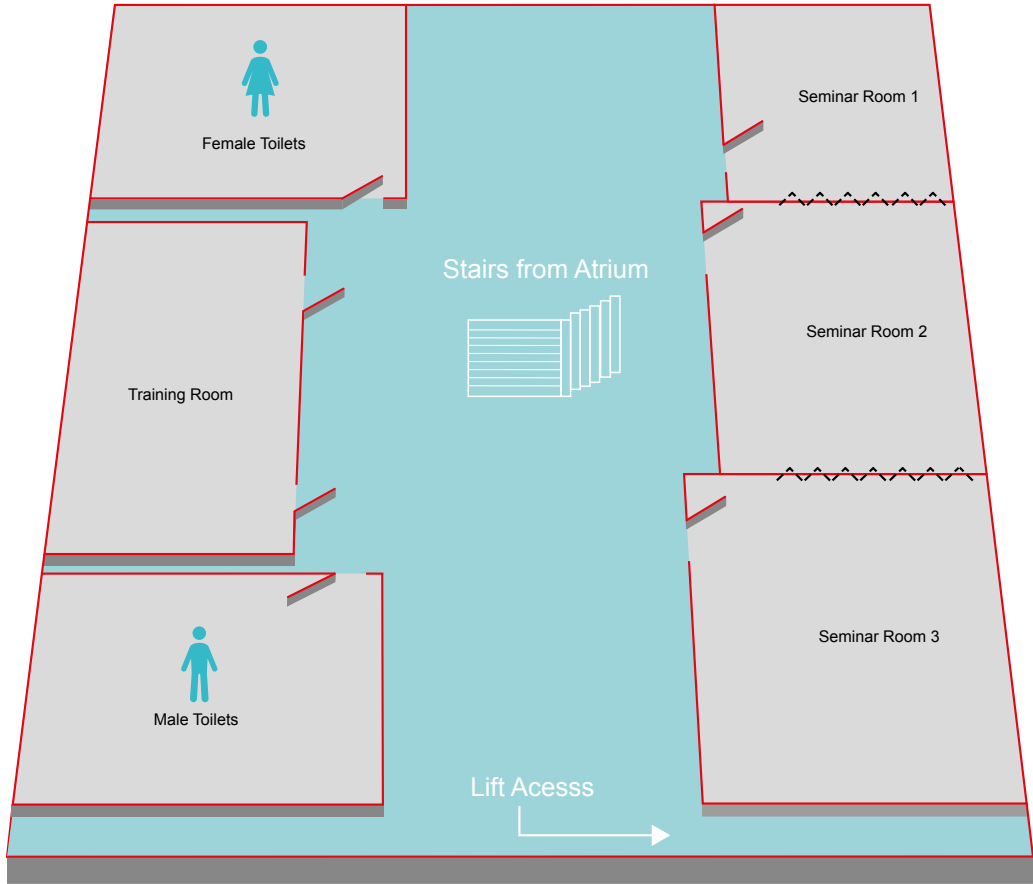

Seminar Room 1



Seminar Rooms Entire Suite



Training Room



Seminar Room 3

3rd FLOOR

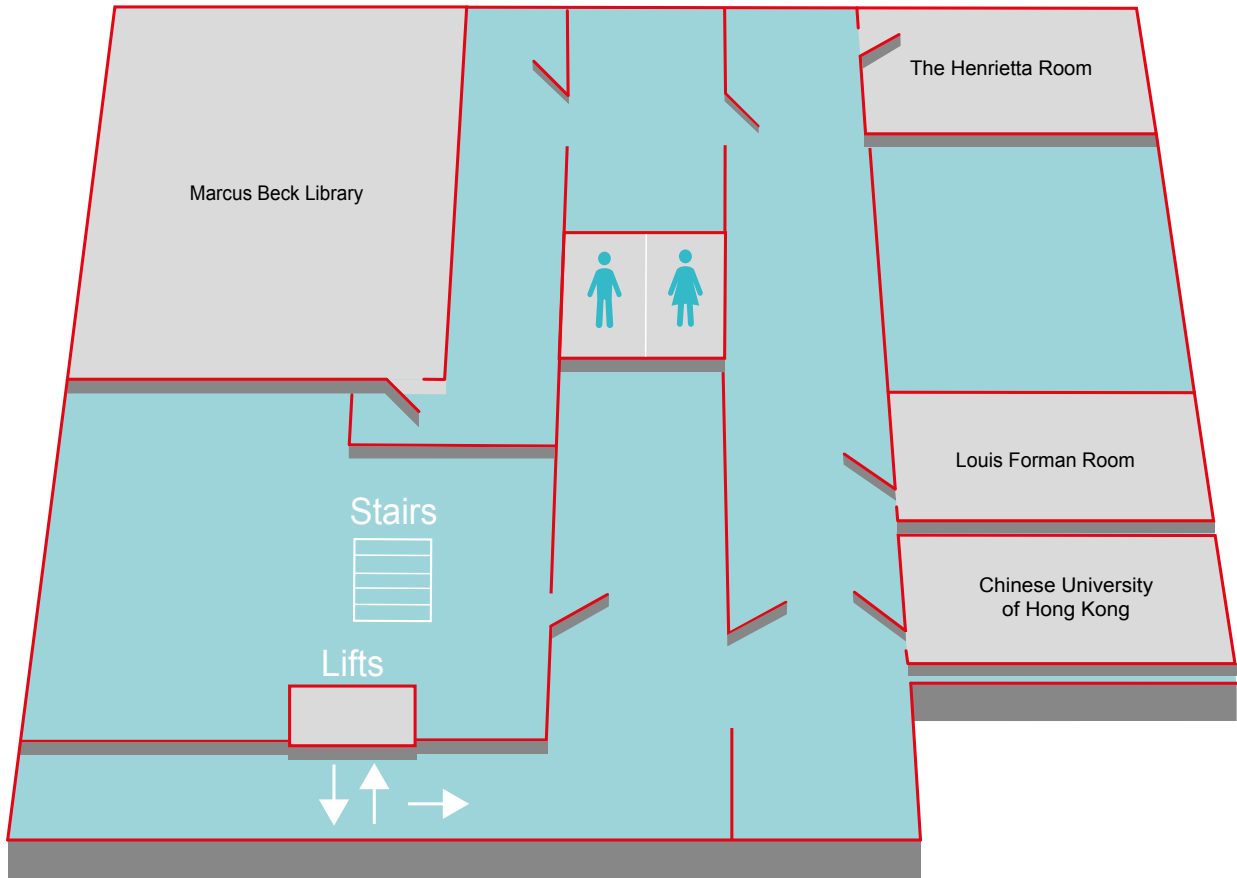

The Henrietta Room



Marcus Beck Library



Chinese University of Hong Kong



Louis Forman Room