

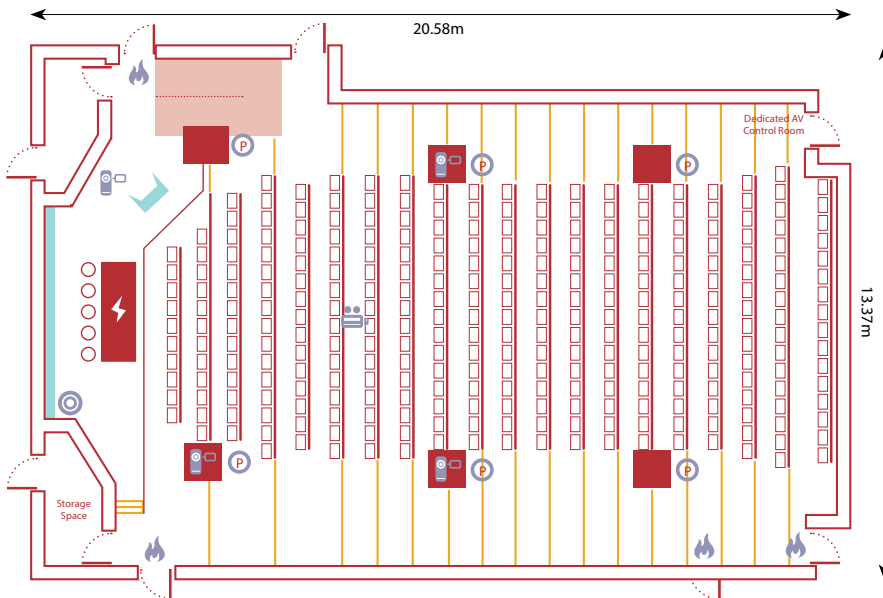

# ROOM GUIDE: Guy-Whittle Auditorium



## CAPACITIES

Theatre: 300

## DIMENSIONS

Length: 20.58m

Width: 13.37m

Height: (highest point): 3.54m

Screen size: 6.44 x 3.15

## KEY ITEMS INCLUDED IN ROOM HIRE

- Assistive listening systems
- Colour LED lighting
- Confidence monitors
- Dedicated AV technician and control room
- 4K Ultra high definition, high contrast projector
- Internet access with Wi-Fi
- Laser pointer/clicker
- Lectern
- PA system with wireless microphones
- Presenters preparation area with live feed from auditorium
- Pull out writing tablets on all chairs
- Top table

- 🎯 Climate Control
- 🔥 Fire Exit
- ⚡ Power Plug
- 📹 Video Camara
- 🎤 Projector
- 📄 Lectern with Interactive Monitor

- Pillar
- Ⓟ Power Point
- 📺 Projector Screen
- 🖼️ Glass Window
- 🚪 Step

# FLOOR GUIDE

## 3rd FLOOR

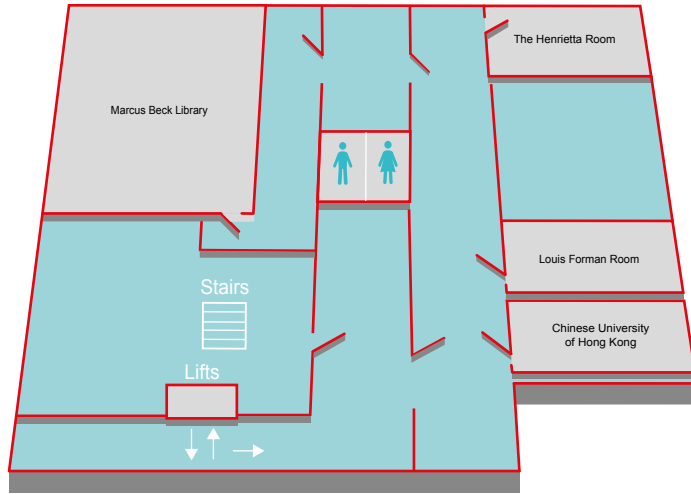

## GROUND FLOOR



## LOWER GROUND FLOOR

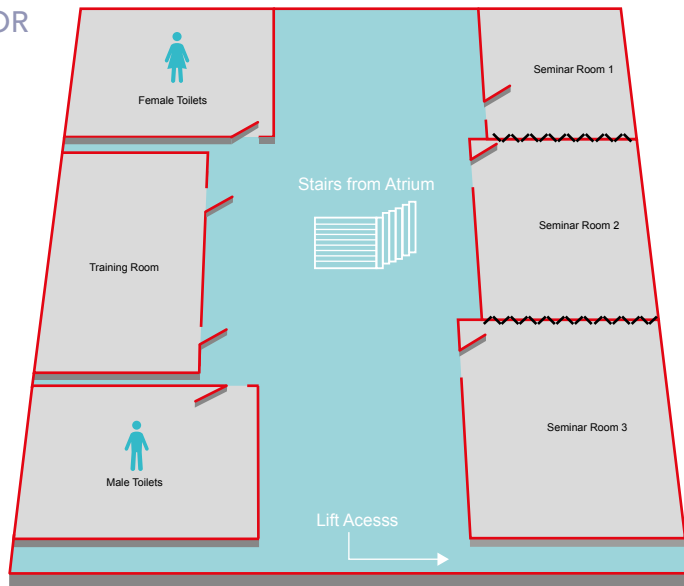

# GROUND FLOOR

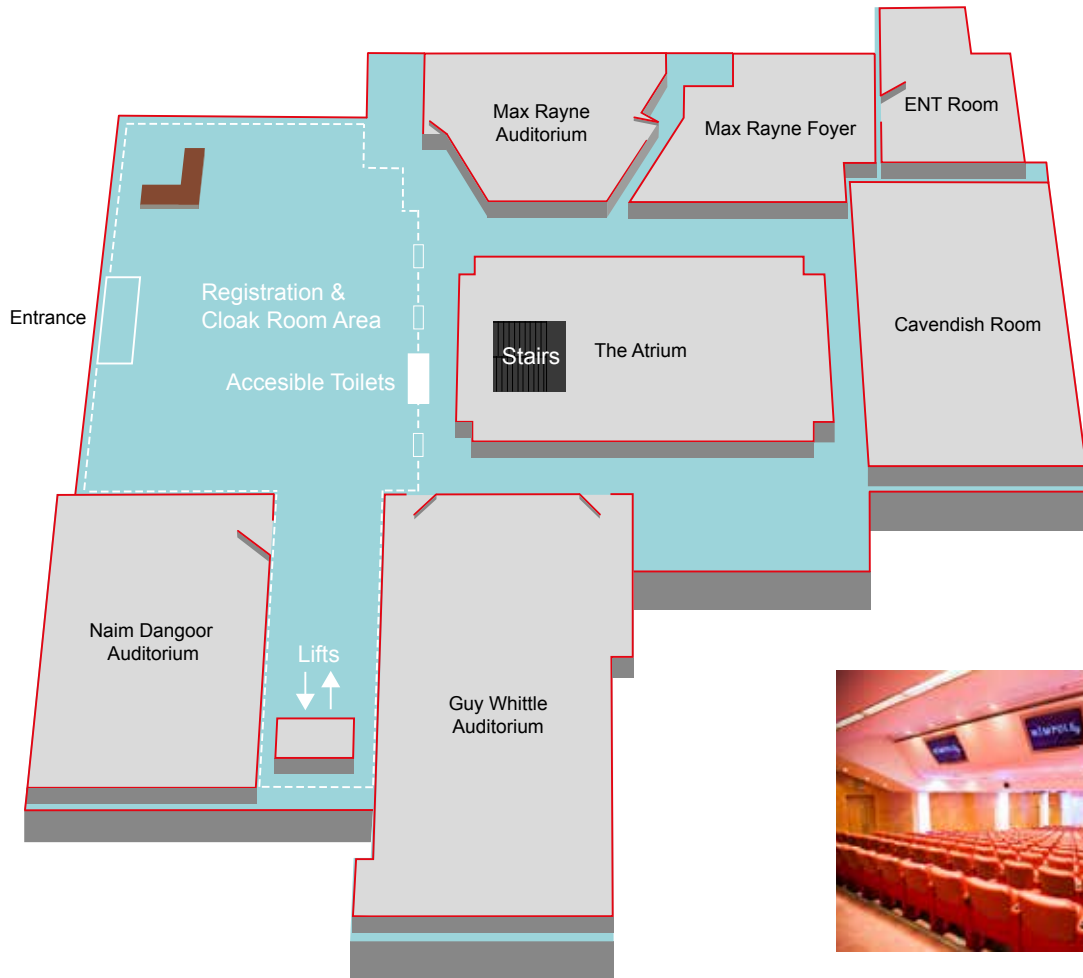

Guy Whittle Auditorium



Naim Dangoor Auditorium



ENT Room



The Atrium



Max Rayne Auditorium



Max Rayne Foyer



Cavendish Room

# LOWER GROUND FLOOR

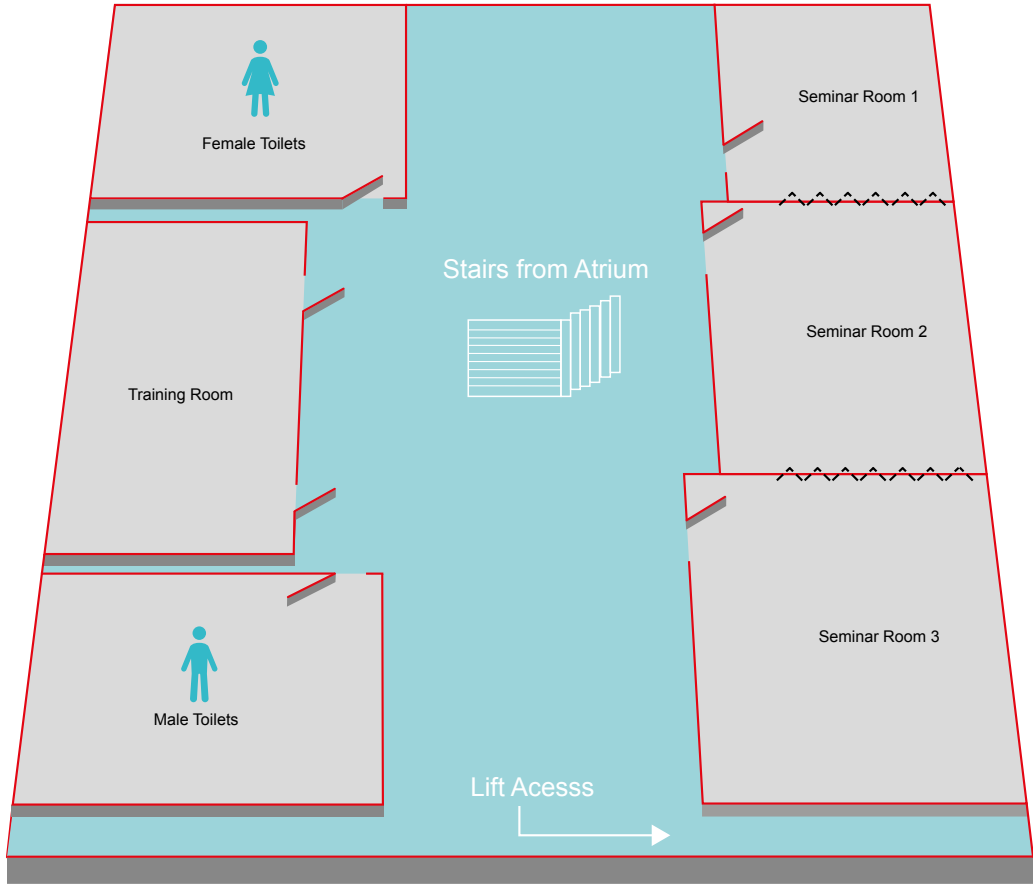

Seminar Room 1



Seminar Rooms Entire Suite



Training Room



Seminar Room 3

# 3rd FLOOR

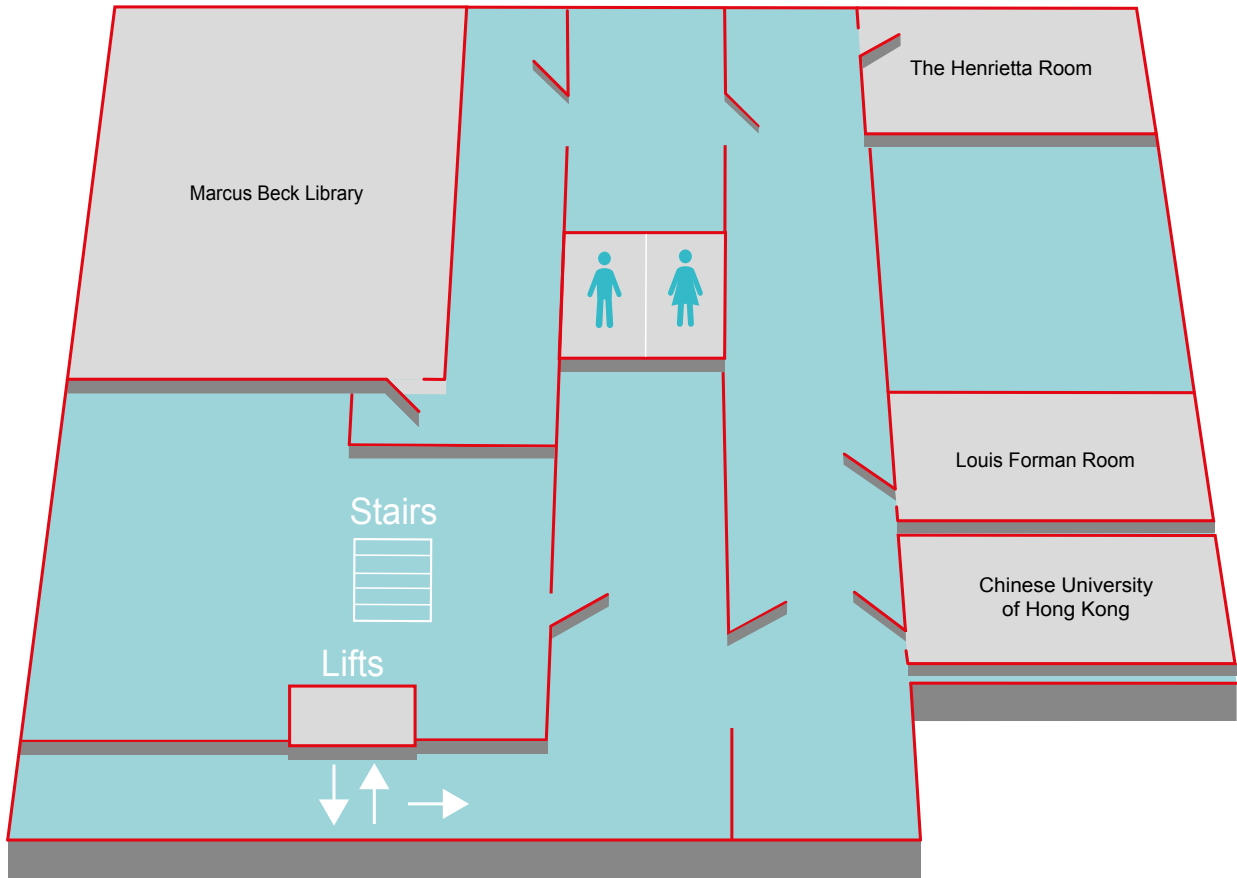

The Henrietta Room



Marcus Beck Library



Chinese University of Hong Kong



Louis Forman Room