

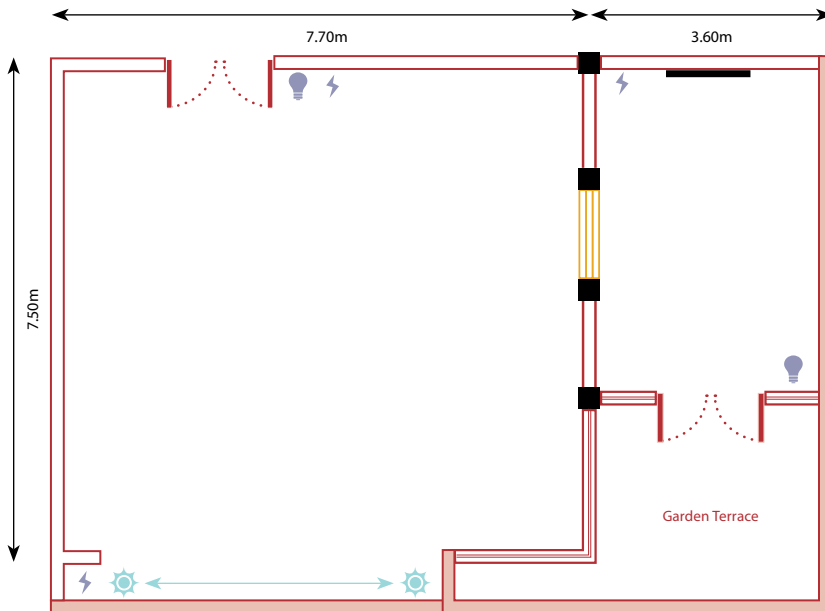

WIMPOLE_{St}

ROOM GUIDE: Toynee Mackenzie ENT Room



CAPACITIES

- Theatre:** 40
- Boardroom:** 22
- Cabaret:** 24
- Reception:** 50
- Standing Buffet:** 40
- Seated Buffet:** 30
- Banquet:** 40

DIMENSIONS

- Length:** 11.30m
- Width:** 7.50m
- Height:** (highest point): 2.99m

KEY ITEMS INCLUDED IN ROOM HIRE

- Internet access with Wi-Fi
- Raised catering area
- Small garden terrace
- Wood-panelling throughout

- 💡 Light Control
- ⚡ Power Plug
- ☀️ Skylight
- 🪟 Glass Window

- Pillar
- ▬ LCD Screen
- ▬ Step

FLOOR GUIDE

3rd FLOOR

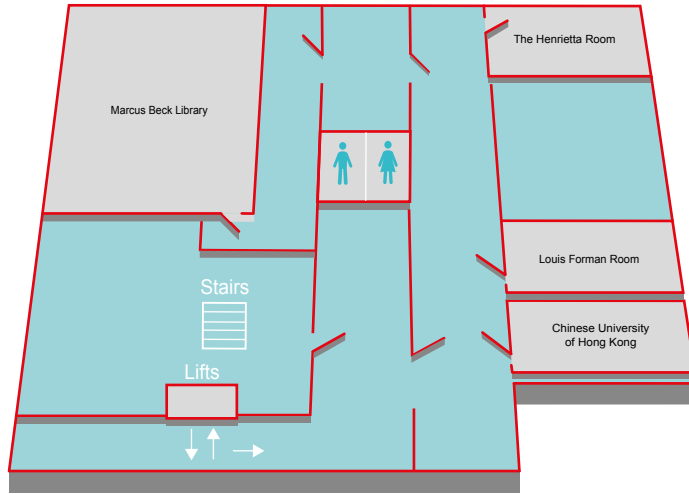

GROUND FLOOR



LOWER GROUND FLOOR

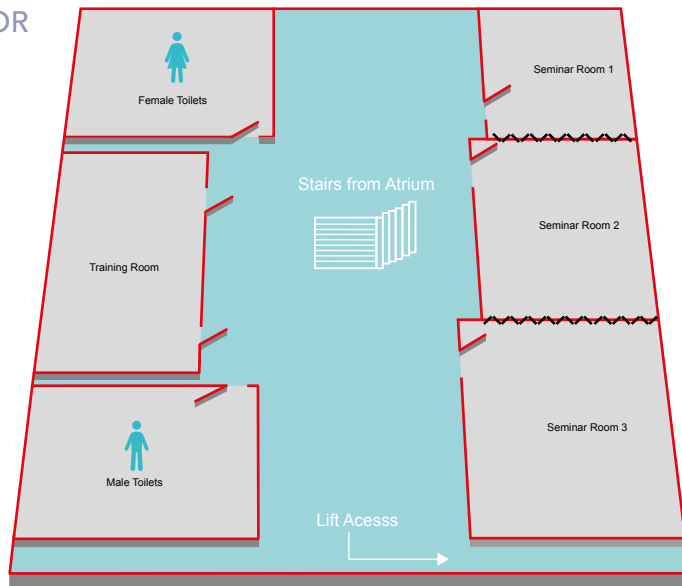

GROUND FLOOR

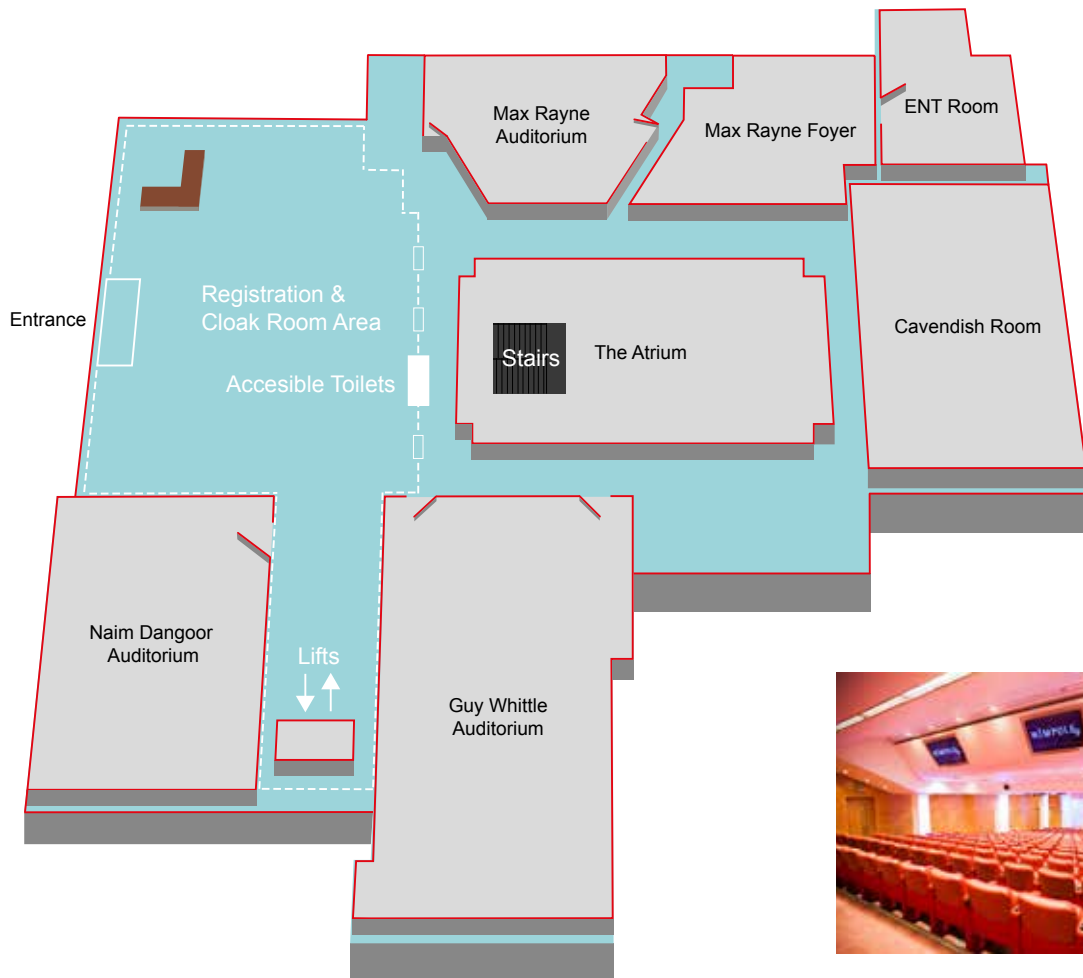

Guy Whittle Auditorium



Naim Dangoor Auditorium



ENT Room



The Atrium



Max Rayne Auditorium



Max Rayne Foyer



Cavendish Room

LOWER GROUND FLOOR

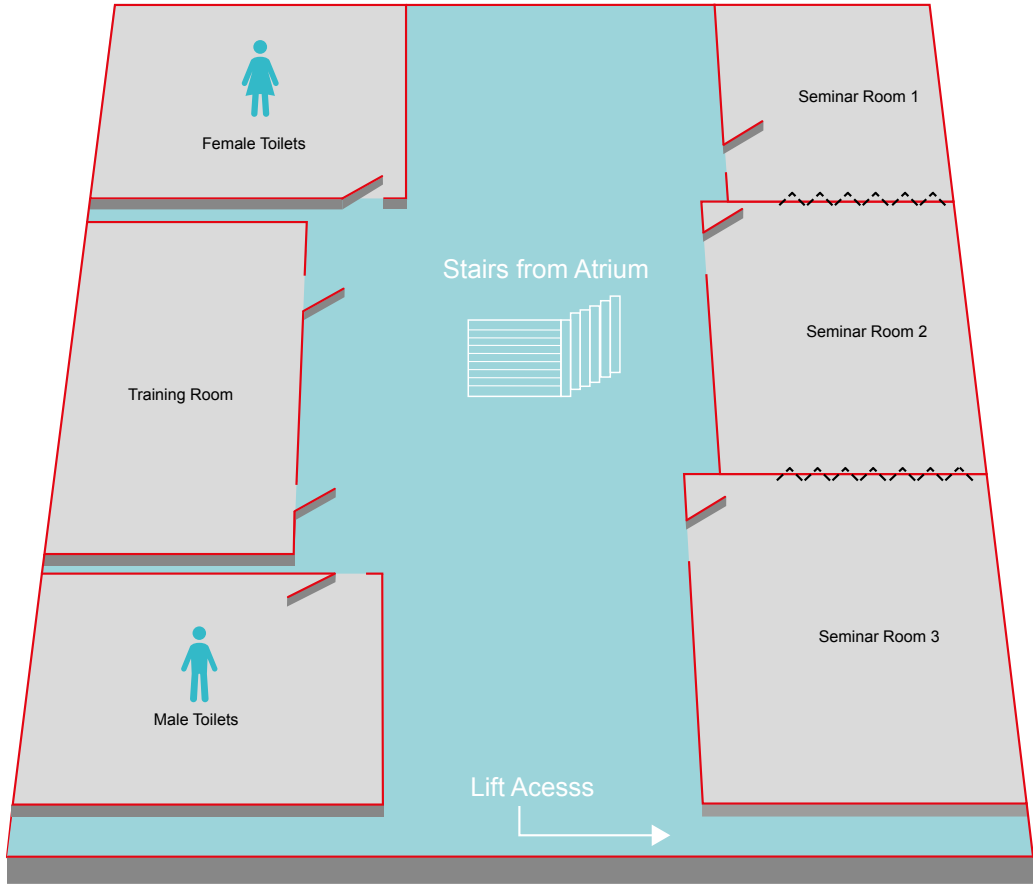

Seminar Room 1



Seminar Rooms Entire Suite



Training Room



Seminar Room 3

3rd FLOOR

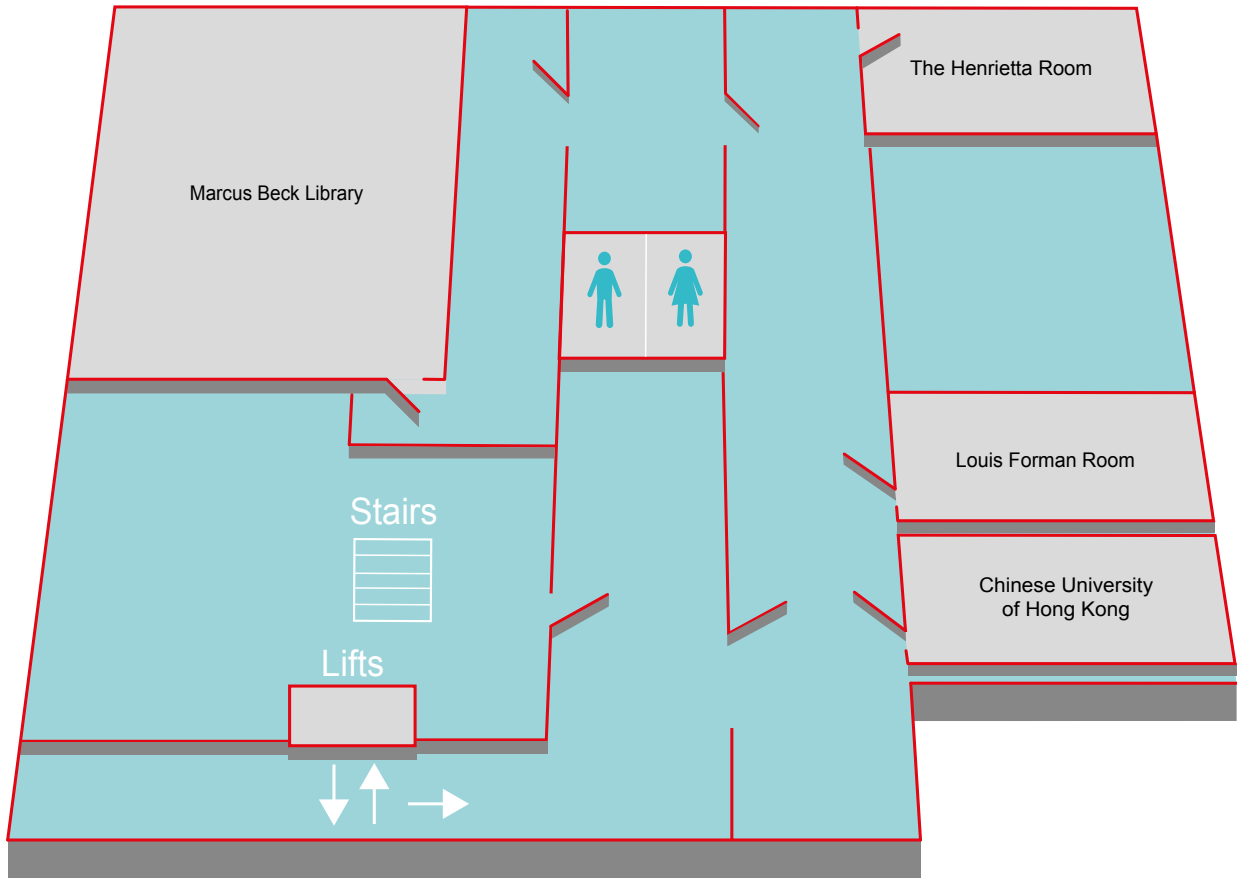

The Henrietta Room



Marcus Beck Library



Chinese University of Hong Kong



Louis Forman Room