

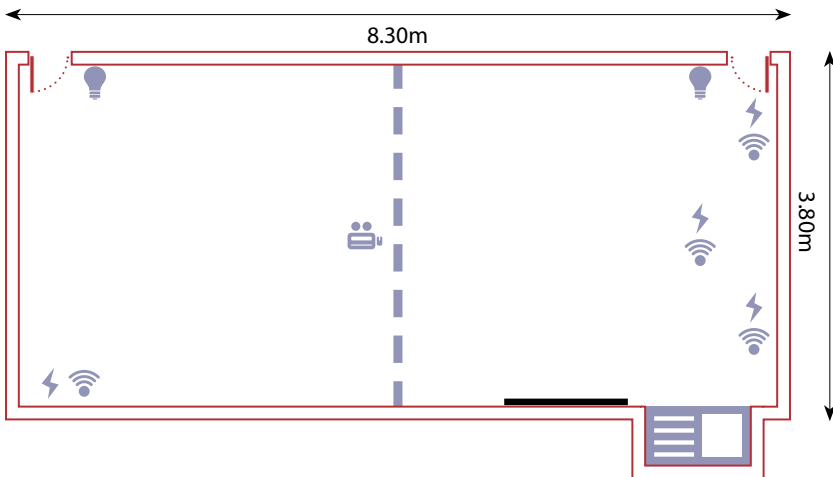

WIMPOLE_{St}

ROOM GUIDE: Training Suite



CAPACITIES

Theatre: 25
Boardroom: 18

DIMENSIONS

Length: 8.30m
Width: 3.80m
Height: (highest point): 2.20m

KEY ITEMS INCLUDED IN ROOM HIRE

- Projector & screen
- Internet access with Wi-Fi
- Lectern
- Partition wall
- Sink
- Wipe clean floor

- ⚡ Power Plug
- 📶 Wired Internet Access
- 📽️ Projector
- 💡 Light Control

- 🗑️ Sink Area
- - - Moveable Wall
- ▬ LCD Screen
- ▬ Projector Screen

FLOOR GUIDE

3rd FLOOR

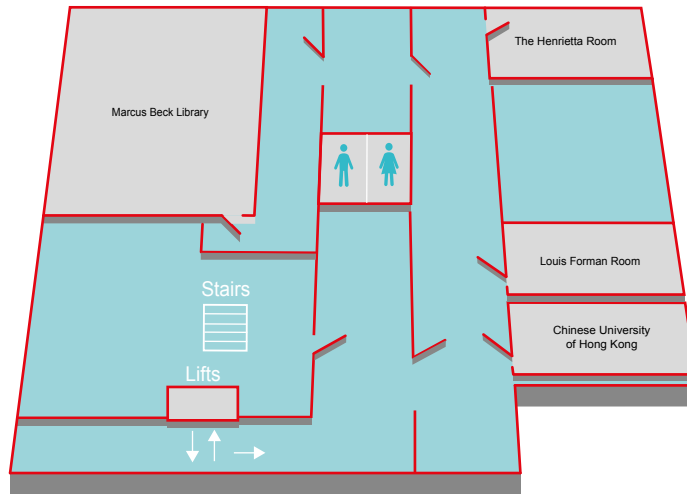

GROUND FLOOR



LOWER GROUND FLOOR

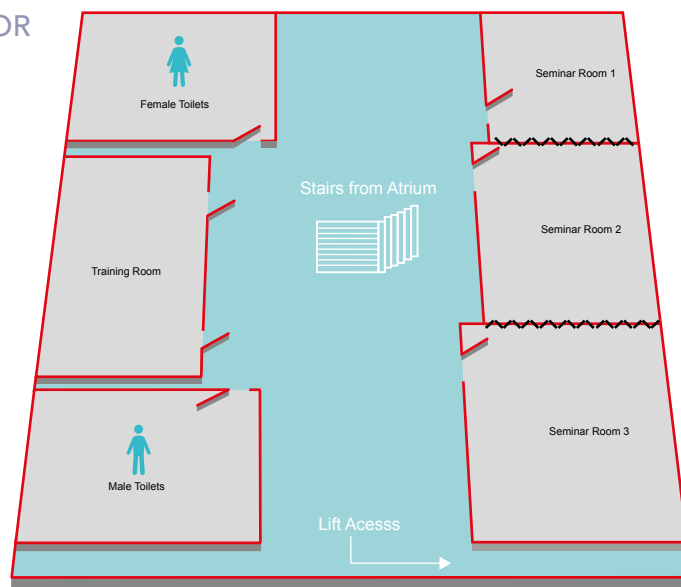

GROUND FLOOR

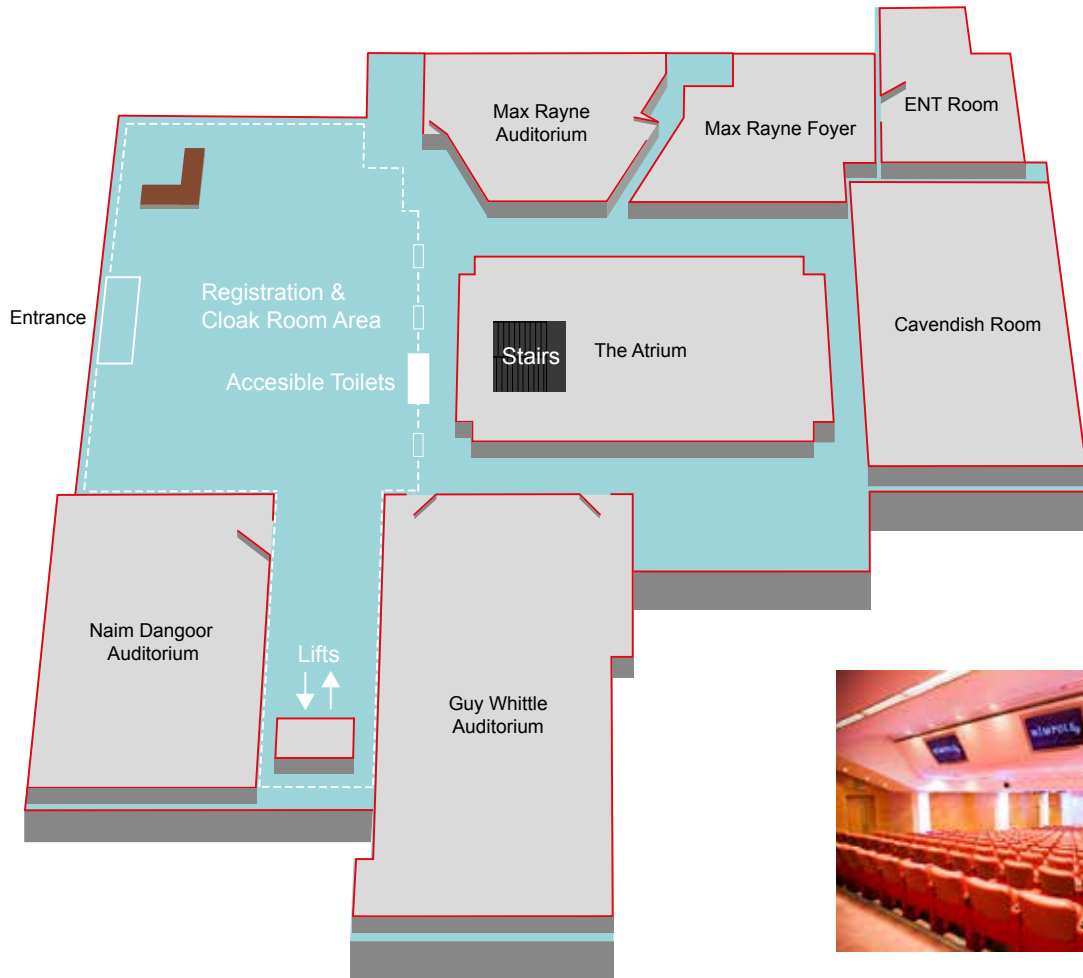

Guy Whittle Auditorium



Naim Dangoor Auditorium



ENT Room



The Atrium



Max Rayne Auditorium



Max Rayne Foyer



Cavendish Room

LOWER GROUND FLOOR

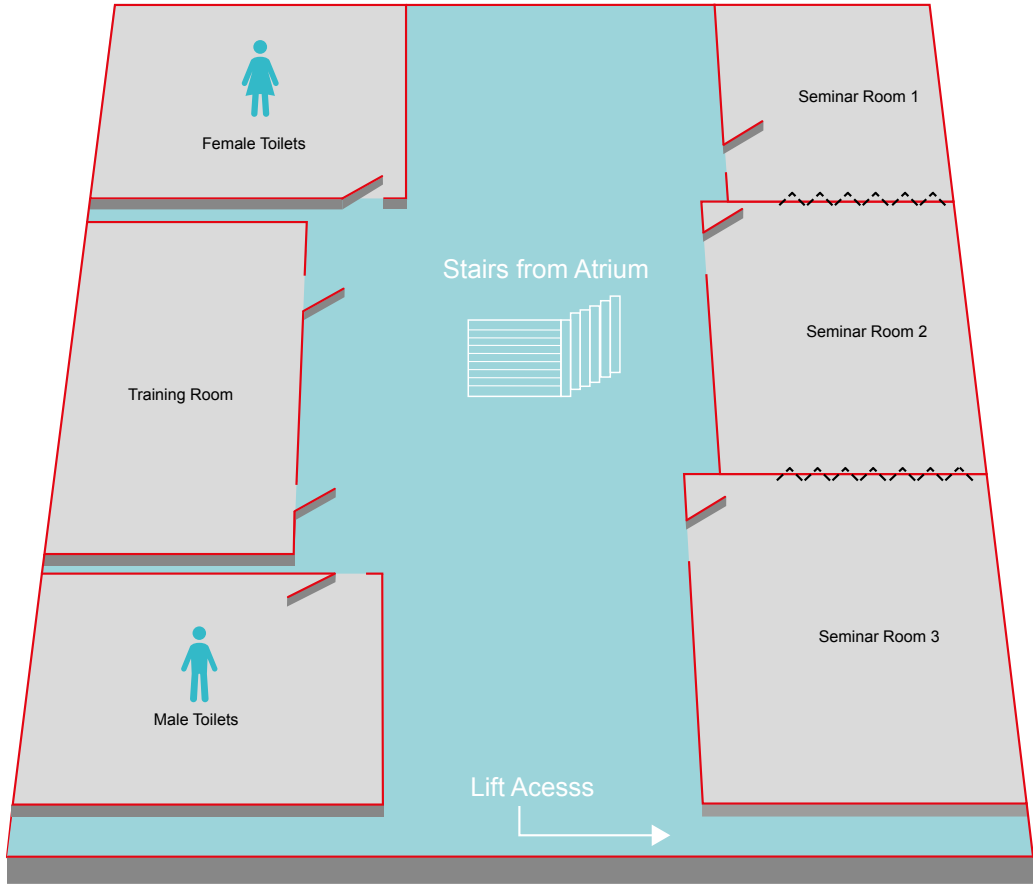

Seminar Room 1



Seminar Rooms Entire Suite



Training Room



Seminar Room 3

3rd FLOOR

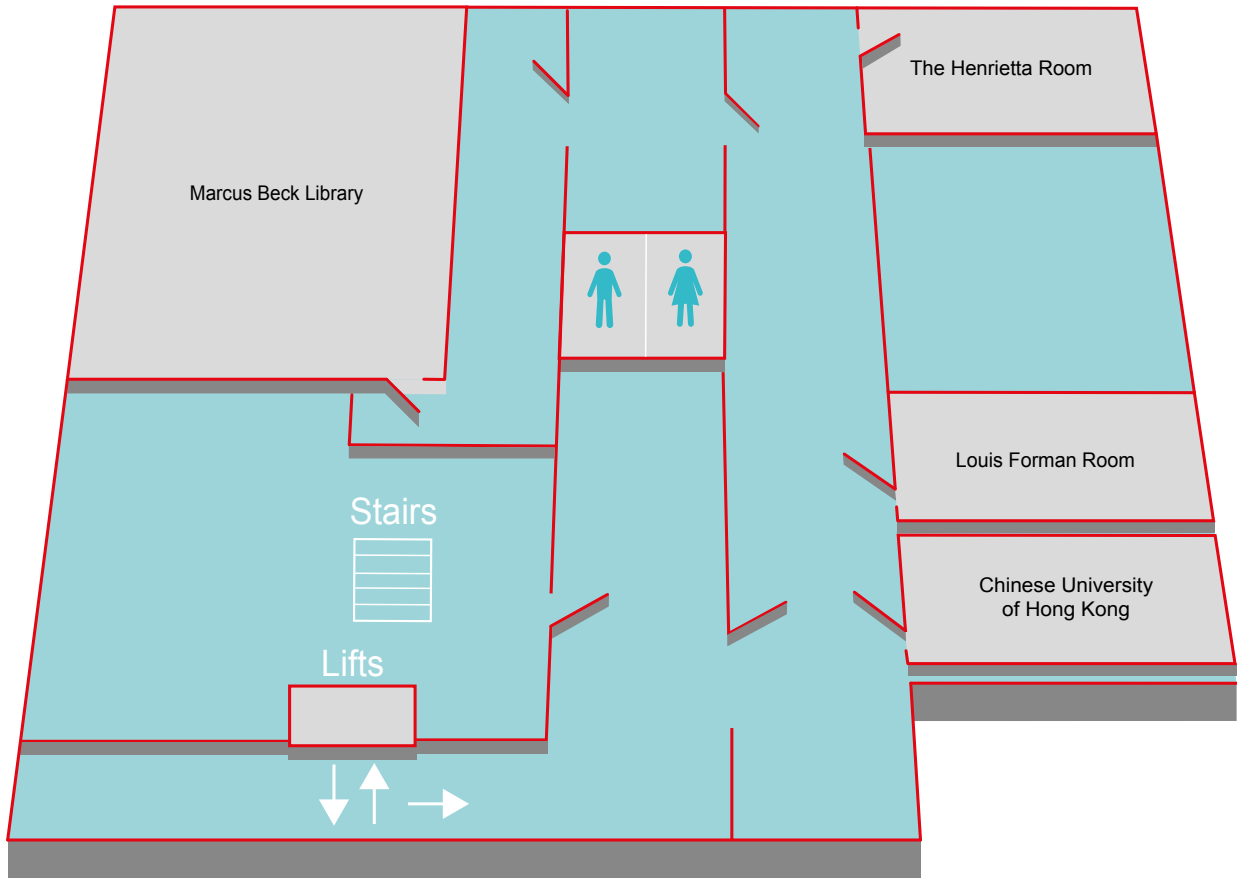

The Henrietta Room



Marcus Beck Library



Chinese University of Hong Kong



Louis Forman Room