

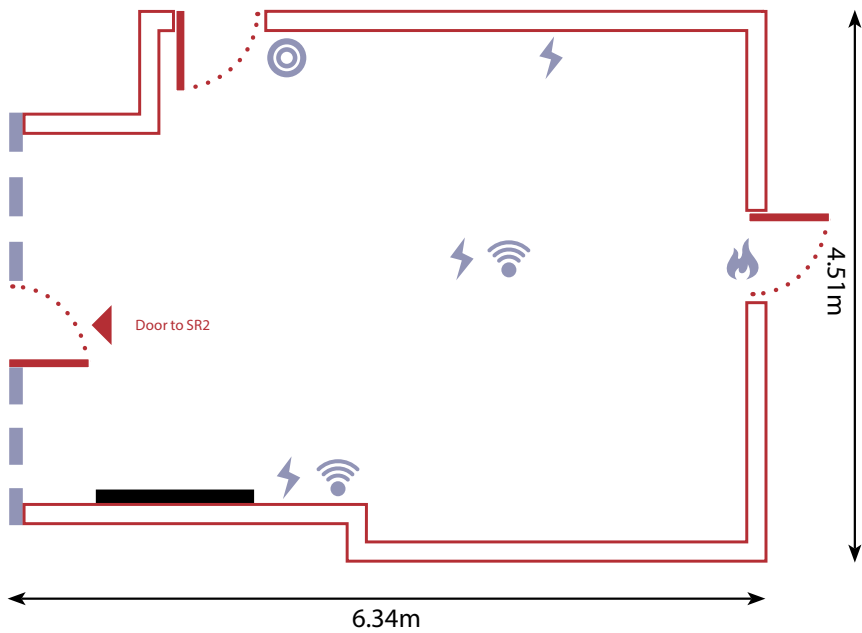

WIMPOLE_{St}

ROOM GUIDE: Seminar Room 1



CAPACITIES



- Theatre:** 15
- Boardroom:** 12
- Reception:** 20
- Standing Buffet:** 15

DIMENSIONS

- Length:** 6.34m
- Width:** 4.51m
- Height:** (highest point): 2.60m

KEY ITEMS INCLUDED IN ROOM HIRE

- 52" HD LCD monitor
- Internet access with Wi-Fi

-  Climate Control
-  Wired Internet Access
-  Power Plug
-  LCD Screen
-  Fire Exit
-  Moveable Wall

FLOOR GUIDE

3rd FLOOR

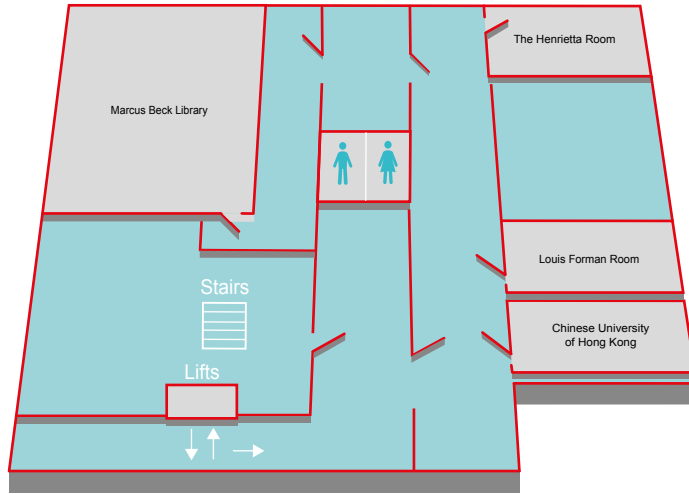

GROUND FLOOR



LOWER GROUND FLOOR

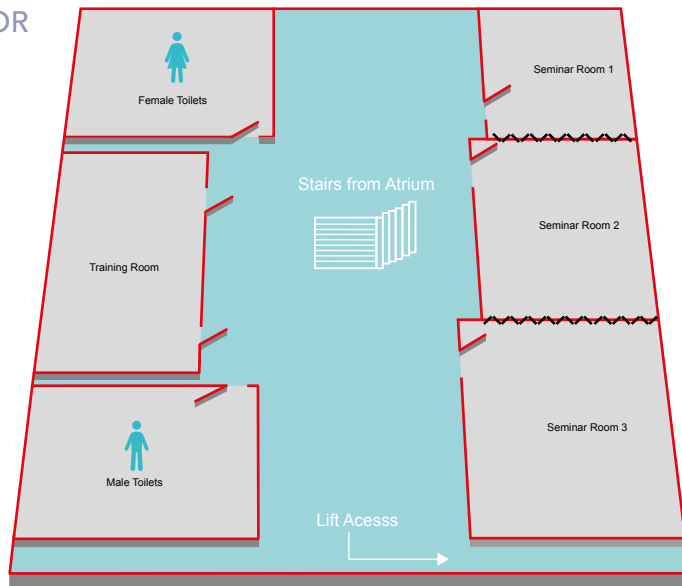

GROUND FLOOR

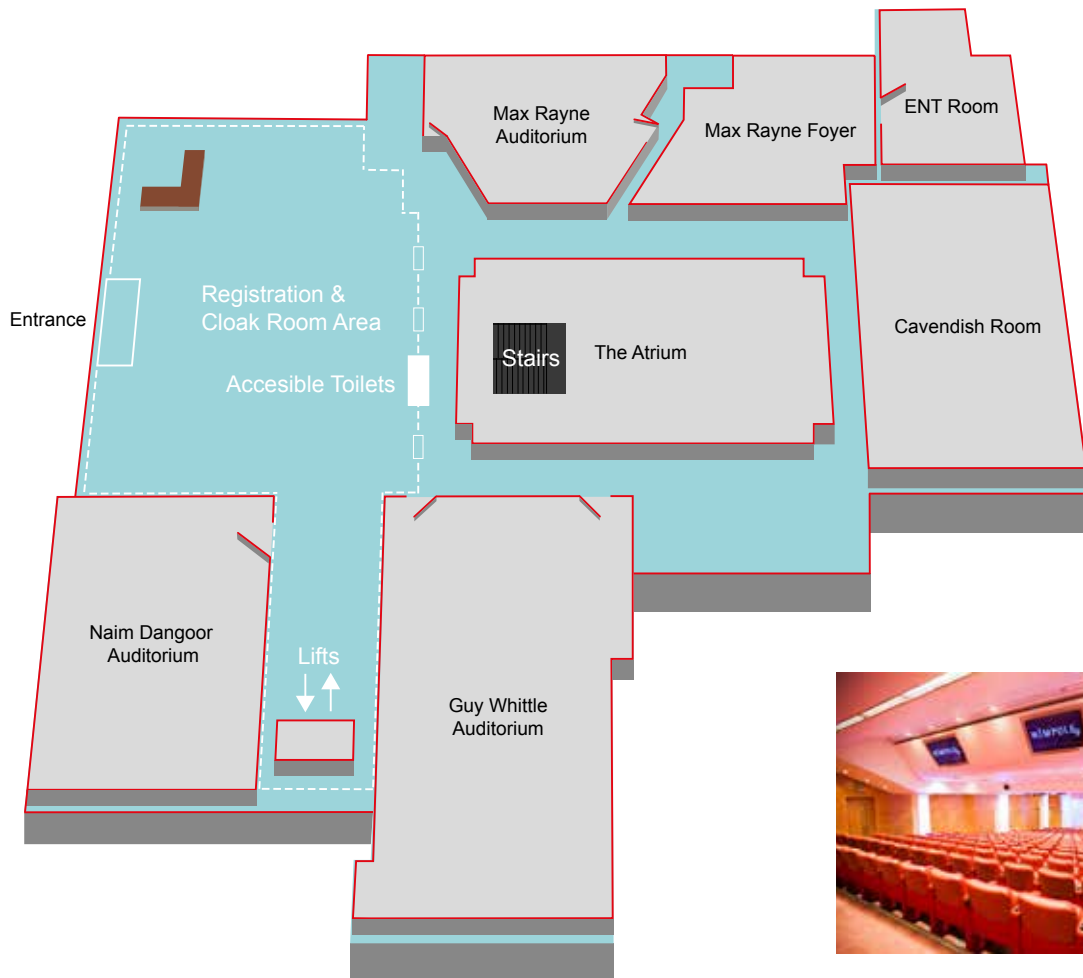

Guy Whittle Auditorium



Naim Dangoor Auditorium



ENT Room



The Atrium



Max Rayne Auditorium



Max Rayne Foyer



Cavendish Room

LOWER GROUND FLOOR

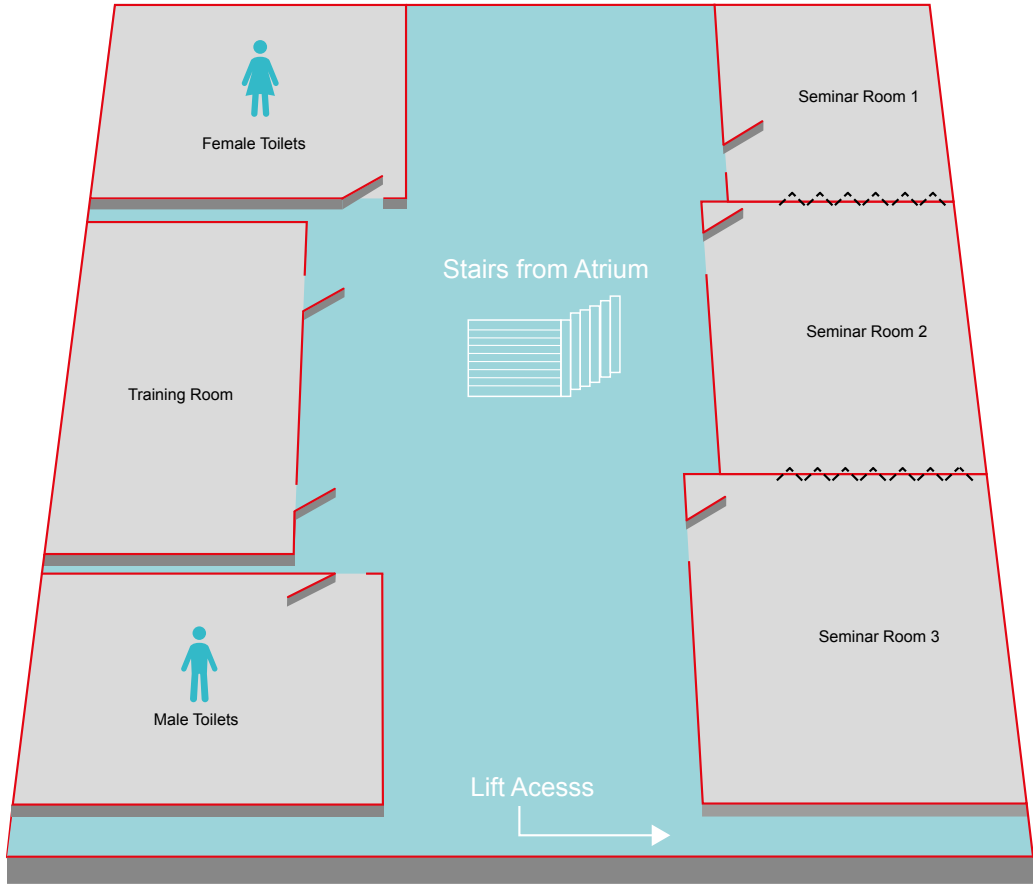

Seminar Room 1



Seminar Rooms Entire Suite



Training Room



Seminar Room 3

3rd FLOOR

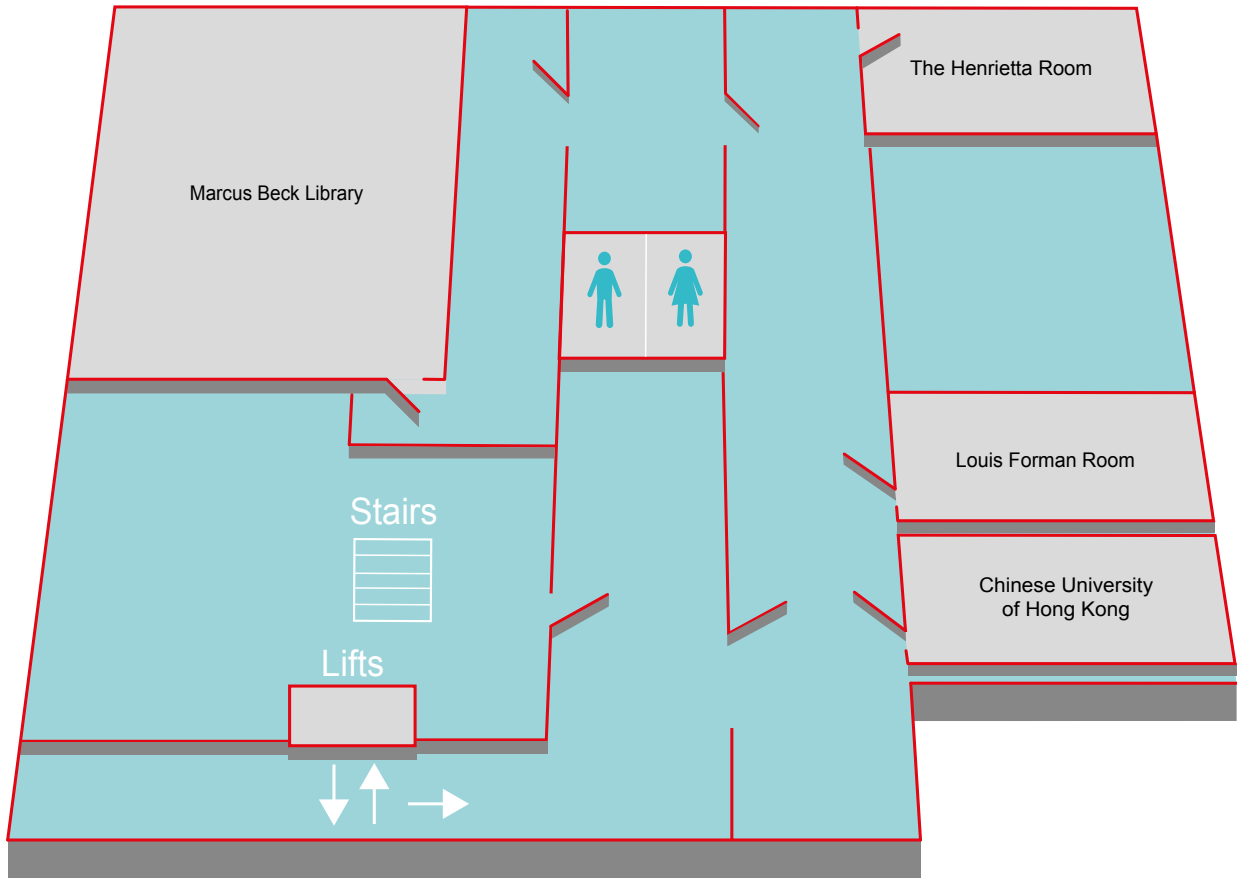

The Henrietta Room



Marcus Beck Library



Chinese University of Hong Kong



Louis Forman Room