

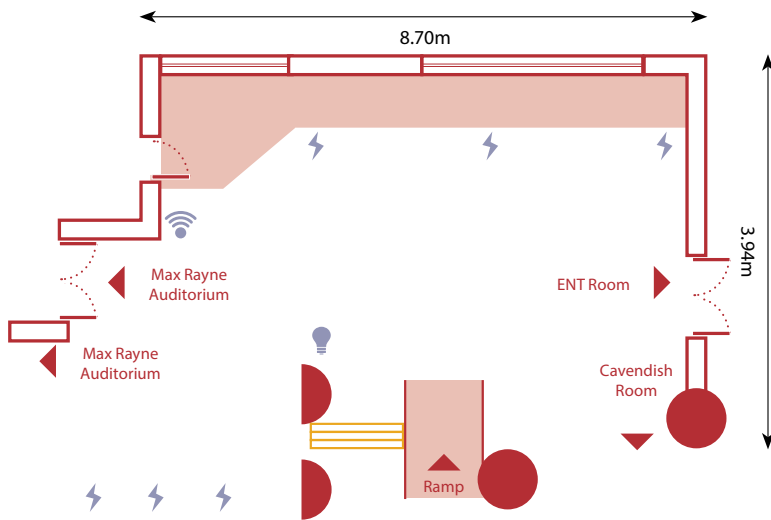

ROOM GUIDE: Max Rayne Foyer



CAPACITIES

Reception: 60
Standing Buffet: 60
Seated Buffet: 40
Banquet: 40

DIMENSIONS

Length: 8.70m
Width: 3.94m
Height: (highest point): 2.99m

KEY ITEMS INCLUDED IN ROOM HIRE

- Catering area
- Internet access with Wi-Fi



Power Plug

Pillar

Wired Internet Access

Glass Window

Light Control

Step

FLOOR GUIDE

3rd FLOOR

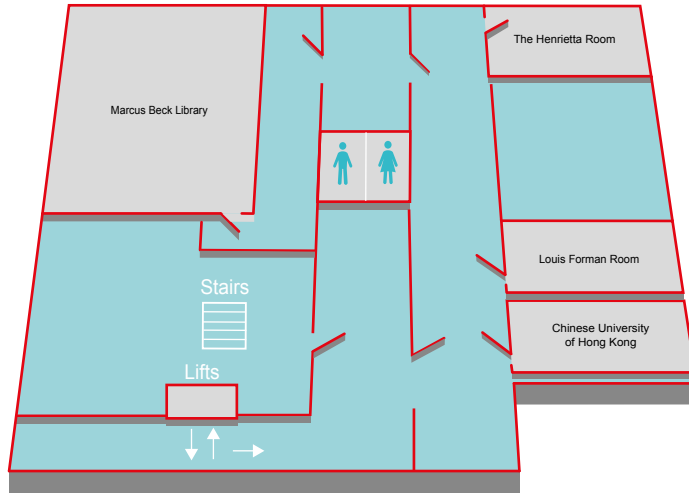

GROUND FLOOR



LOWER GROUND FLOOR

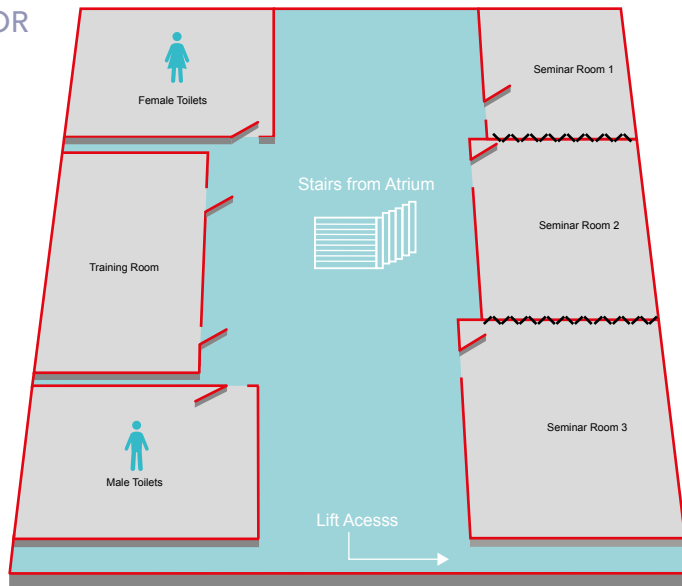

GROUND FLOOR

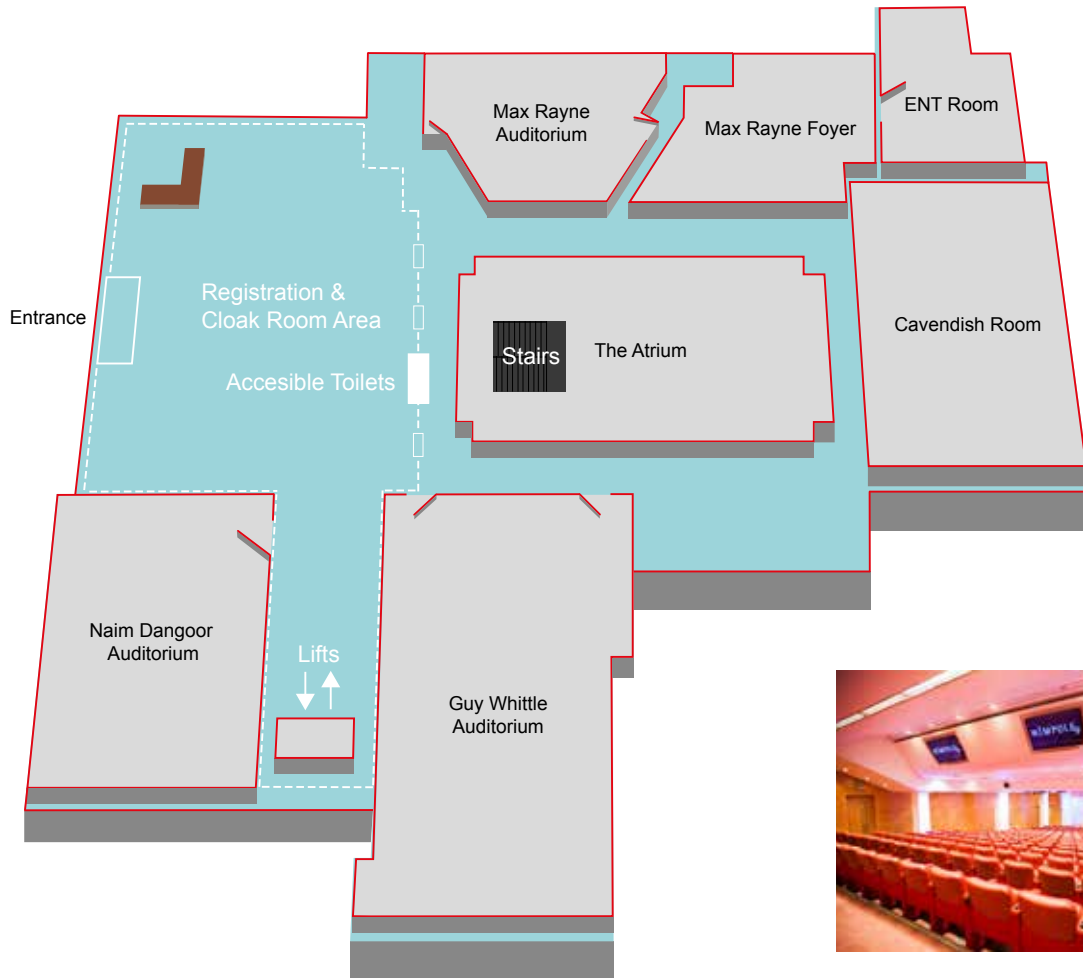

Guy Whittle Auditorium



Naim Dangoor Auditorium



ENT Room



The Atrium



Max Rayne Auditorium



Max Rayne Foyer



Cavendish Room

LOWER GROUND FLOOR

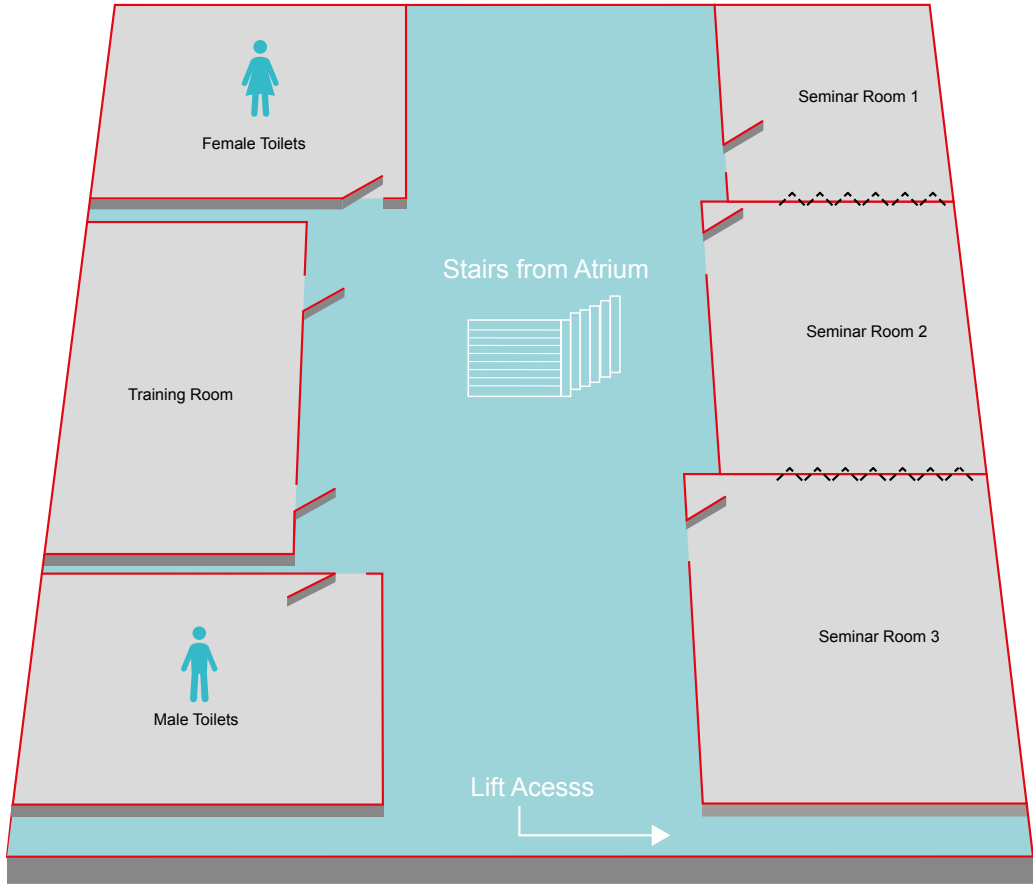

Seminar Room 1



Seminar Rooms Entire Suite



Training Room



Seminar Room 3

3rd FLOOR

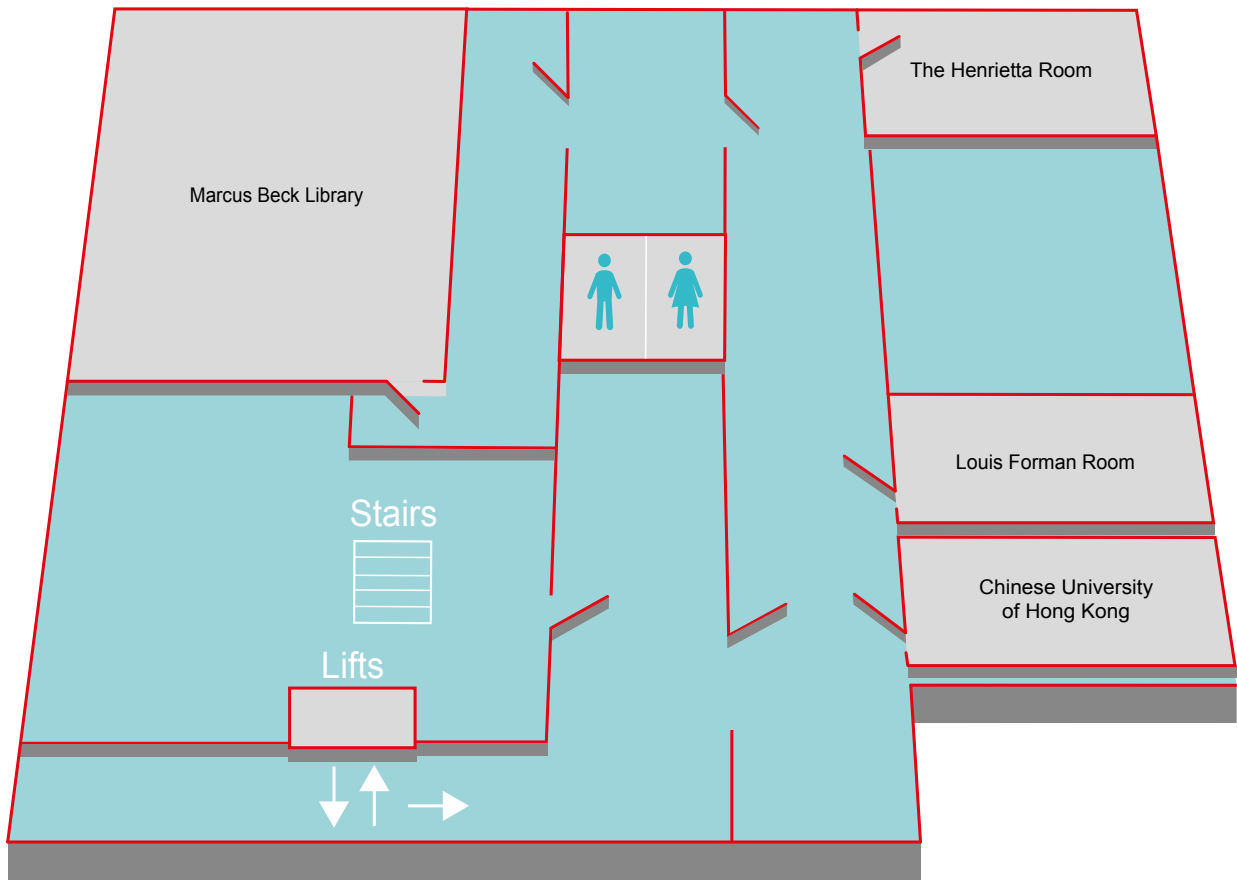

The Henrietta Room



Marcus Beck Library



Chinese University of Hong Kong



Louis Forman Room