

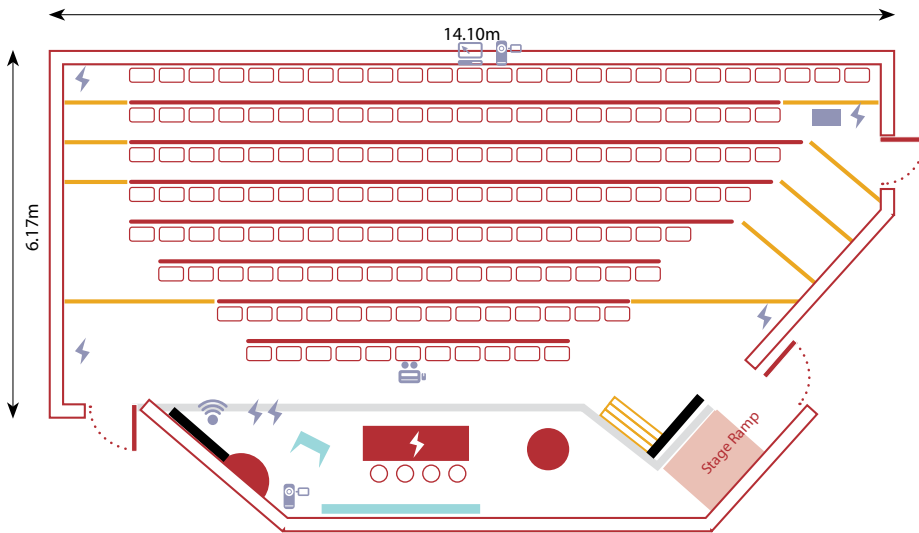

# ROOM GUIDE: Max Rayne Auditorium



## CAPACITIES

**Theatre:** 150

## DIMENSIONS

**Length:** 14.10m

**Width:** 6.17m

**Height:** (highest point): 3.38m

**Screen size:** tbc

## KEY ITEMS INCLUDED IN ROOM HIRE

- Assistive listening systems
- Colour LED lighting
- Confidence monitors available
- Dedicated AV technician and control desk
- High definition, high brightness projector
- Internet access with Wi-Fi
- Laser pointer/clicker
- Lectern
- PA system with wireless microphones
- Top table

 65" Confidence monitor

 Lectern with Interactive Monitor

 Power Plug

 Technician Desk with AV technician

 Wired Internet Access

 Pillar

 Video Camera

 LCD Screen

 Projector

 Projector Screen

 Light Control

 Step

# FLOOR GUIDE

## 3rd FLOOR

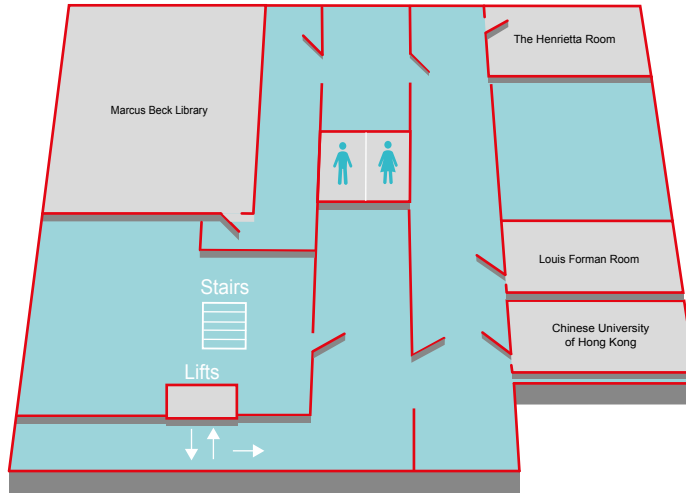

## GROUND FLOOR



## LOWER GROUND FLOOR

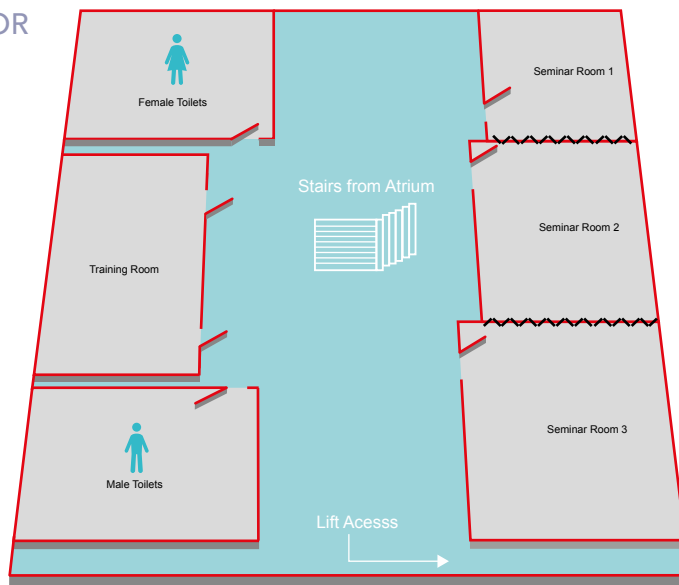

# GROUND FLOOR

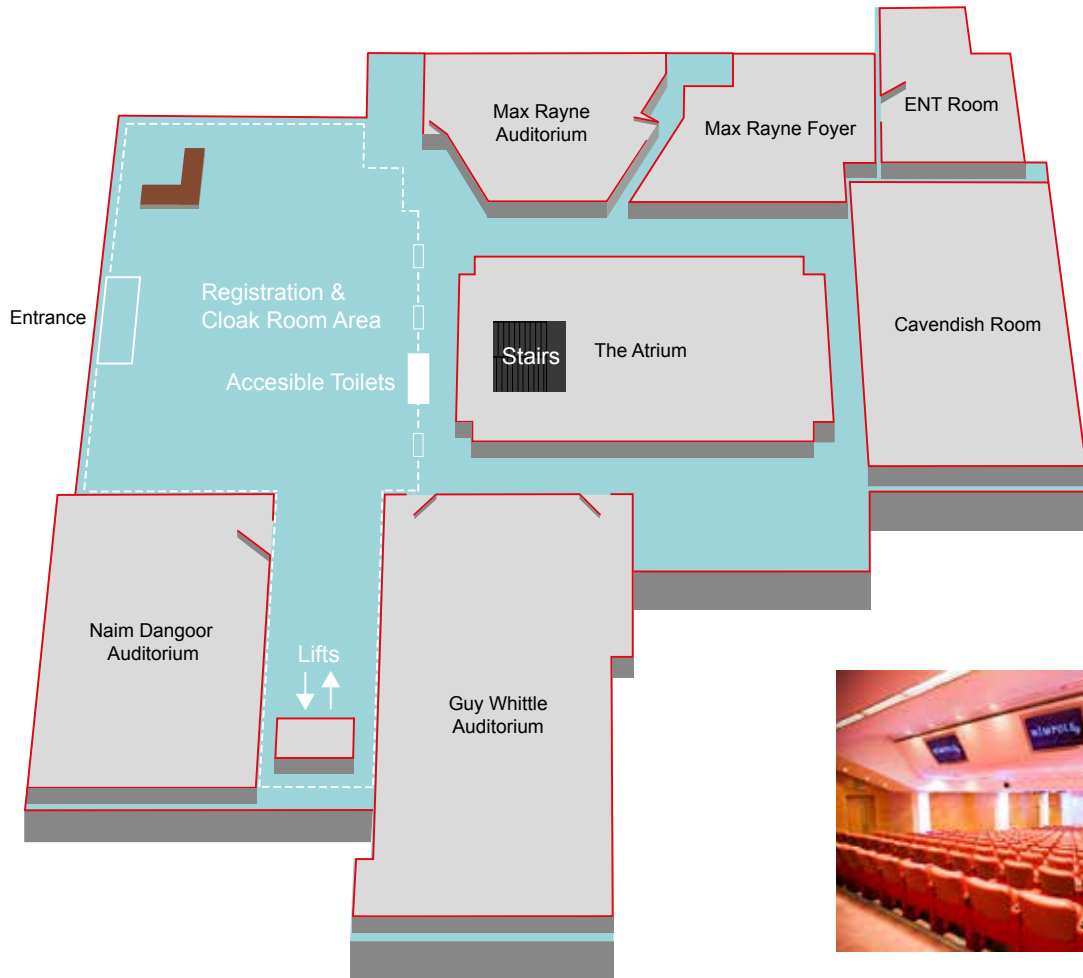

Guy Whittle Auditorium



Naim Dangoor Auditorium



ENT Room



The Atrium



Max Rayne Auditorium



Max Rayne Foyer



Cavendish Room

# LOWER GROUND FLOOR

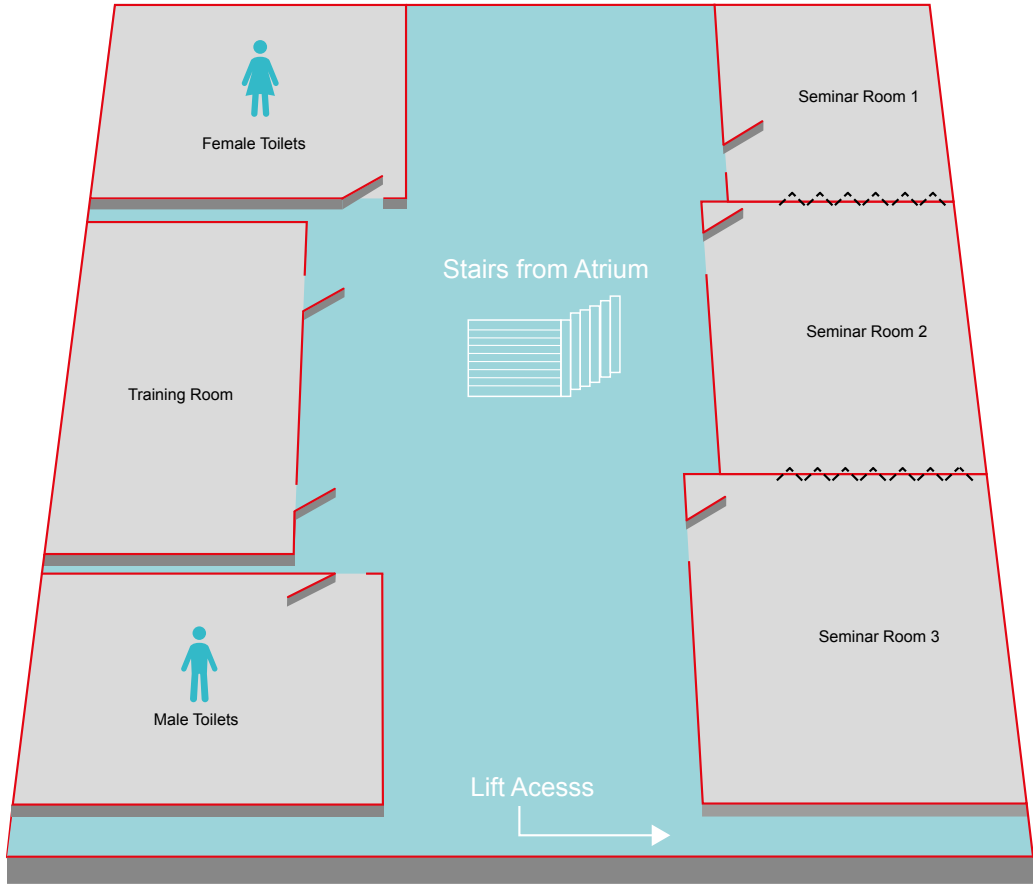

Seminar Room 1



Seminar Rooms Entire Suite



Training Room



Seminar Room 3

# 3rd FLOOR

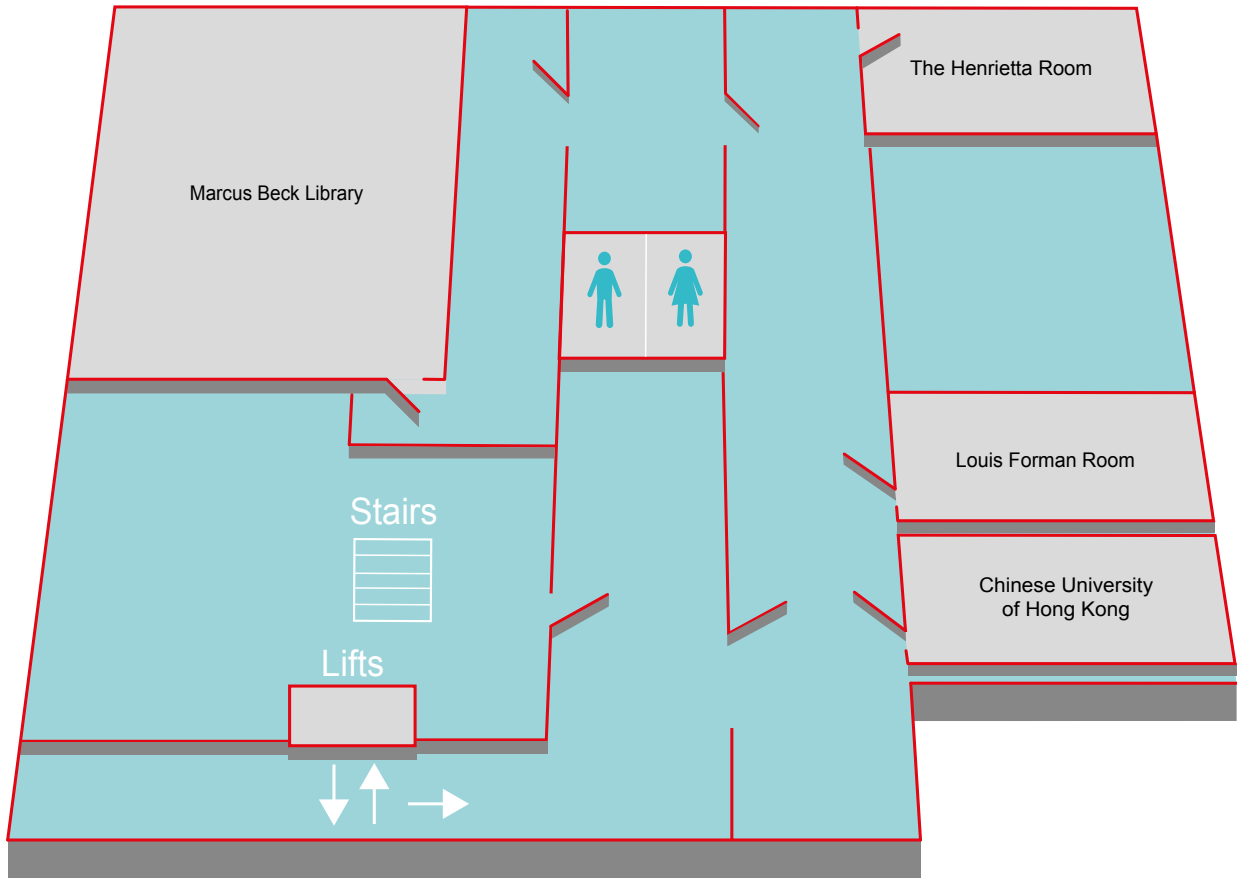

The Henrietta Room



Marcus Beck Library



Chinese University of Hong Kong



Louis Forman Room